

Woodley Lab Systems, Critical Care & Rapid Diagnostic Tests

Product Guide - Issue 2.2

Blood Gas/
Critical Care



Electrolytes



Laboratory
Information
Systems

InSightTM
Lab
Manager



Haematology



Coagulation



Clinical
Chemistry



Immunofluorescence
Diagnostics



Rapid
Diagnostic Tests



InSightTM Urinalysis



Tel: +44 (0) 1204 669033 (Option 1)
Fax: +44 (0) 1204 669034
Email: sales@woodleyequipment.com
Web: www.woodleyequipment.com

WOODLEY
EQUIPMENT COMPANY LTD.

OLD STATION PARK BUILDINGS, ST. JOHN STREET, HORWICH, BOLTON, LANCASHIRE, BL6 7NY, UK

The Critical Care Diagnostic Range:

epoc Critical Care / Blood Gas Analyser

UK's leading hand held Critical Care/Blood Gas Analyser is about to get better!

Test card contains all parameters:

Na⁺, K⁺, Cl⁻, Ca⁺⁺, Hct, Hgb*, Glu, Lac, Creatinine, pH, pCO₂, pO₂, HCO₃^{-*}, BE(b)*, BE (ecf)*, SO₂*, AGapK, TCO₂* *Calculated parameter **Blood Urea & measured TCO₂ on every card at no additional cost coming very soon!**

Features

- Accurate blood gas, electrolyte and critical care biochemistry results in 3 minutes
- Room temperature cartridge storage
- 92µl sample volume
- Veterinary software with species-specific reference ranges
- Completely portable handheld system with rechargeable battery & bluetooth printer
- Ready to use anytime, anywhere. In-practice, theatre, patient side or equine yard
- Integrated calibration and quality checks on each test card
- Ability to input all patient data, species, temperature and even ventilator settings
- WiFi and bluetooth connectivity for easy transfer to practice management systems

*epoc + Hemocue WBC = Rapid Pathological Screening
24 hours a day*



SIEMENS
Healthineers

RAPIDPoint 500 Blood Gas Systems

*Ideal for sites with the
larger workload*

SIEMENS
Healthineers

RAPIDPoint 500 Tests

Blood Gas: pH, pO₂, pCO₂

Electrolytes: Na⁺, K⁺, Ca⁺⁺, Cl⁻

Metabolites: Glu, Lac

Co-oximetry: nBili, tHb, SO₂, O₂Hb, HHb, COHb, MetHb

Features & Benefits

- Accurate, lab-quality test results from a single sample in approximately 60 seconds
- Easy to use, reliable, maintenance-free operation with cartridge based system, automatic calibration and QC
- Built in printer and WiFi connectivity for easy transfer of results to practice management systems



InSight™
qLabs® Veterinary
Coagulation Analyser

*In-Practice
point-of-care
coagulation testing*

- Requires 1 drop of non-anticoagulated whole blood (10µl)
- PT/APTT tested simultaneously on 1 test strip
- Room temperature test strip storage
- Fill test strip directly from syringe
- QC material available
- No need to transfer sample into citrate tube
- Low cost analyser and consumables
- 'Test count up' for immediate assessment
- Excellent correlation to central laboratory results
- 2 year warranty



StatStrip® Lactate Xpress Meter

- Results in 13 seconds
- Easy to use and portable
- Small 0.6µl sample size
- Venous or arterial whole blood
- Stores 400 patient results
- No user calibration
- Eliminates interfering substances

**StatSensor Creatinine & NovaVet Blood
Ketone Meters also available - see page 9**



HemoCue® WBC Analyser

The HemoCue WBC measures the number of white blood cells in the sample.

- Simple to use
- Results in 2 minutes
- Ready to use 24 hours a day
- Small sample volume - 10µl
- WBC count available using whole blood and synovial fluid



*Simple to use
& results in
2 minutes*

Tel: +44 (0) 1204 669033 (Option 1)
Fax: +44 (0) 1204 669034
Email: sales@woodleyequipment.com
Web: www.woodleyequipment.com

WOODLEY
EQUIPMENT COMPANY LTD.

OLD STATION PARK BUILDINGS, ST. JOHN STREET, HORWICH, BOLTON, LANCASHIRE, BL6 7NY, UK

Poison Test - Anti-Freeze Ethylene Glycol Testing

Tests for the presence of Ethylene Glycol commonly found in "anti-freeze", lacquer, detergents and de-icers. These test strips report quantitative results of Ethylene Glycol in plasma. Providing critical information on exposure to this toxin for both Felines and Canines in as early as 30 minutes after ingestion.

- Feline & Canine sensitivity at 20 mg/dL
- Only 20µl of Heparin plasma required
- Detects Ethylene Glycol approximately 30 minutes after ingestion
- Results in 10 minutes
- Sample window 12-14 hours post ingestion
(varies by size, age and condition of animal)
- Room temperature storage

Feline & Canine Sensitivity at 20mg/dL

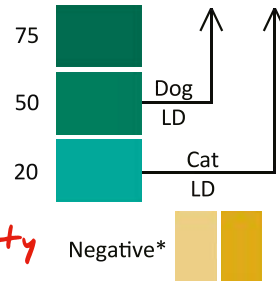

*varies by size, age and condition of animal

DiaSys Blood Urea Test Strips

Quick and easy assessment of the renal function

A quick and easy, low cost test for the quantitative determination of urea in-practice. The length of the blue zone indicates the urea concentration providing an immediate assessment of the patient's renal function.

- One drop of capillary, whole blood, serum or plasma
- Test Time: from 5 minutes
- Room temperature storage
- Small sample volume - 10µl



InSight™ HCT Meter

The InSight™ HCT meter is a low cost handheld meter for the measurement of canine, feline and equine haematocrit and total haemoglobin in capillary and venous whole blood.

- Calibrated for cats, dogs and horses
- 30 second test time
- One drop whole blood (Venous, Capillary or EDTA)
- HCT results reported as %



AliveCor iPhone Veterinary Heart Monitor

Compatible with: iPhone® 4 / 4S / 5 / 5S / 6 / 6S / SE / 7

An ECG device as mobile as you are



i-SMART 30 VET ELECTROLYTE ANALYSER

Fast & Accurate

- Fast, accurate analysis
- Tests electrolytes Na⁺ K⁺ and Cl⁻
- 60µl sample volume
- Results in 35 seconds
- Species specific animal reference ranges

All in One Cartridge

- No user maintenance
- Autocalibration
- Cartridge contains electrodes, all consumables and waste

Features & Advantages

- 300,000 test data storage
- Large, LCD touch screen
- Veterinary specific software
- Battery or mains powered



Fast, accurate & maintenance free In-Practice electrolyte analysis

Measured electrolytes

Na ⁺	20 - 250 mmol/L
K ⁺	0.5 - 20.0 mmol/L
Cl ⁻	20 - 250 mmol/L

g-Pet™ PLUS+

- Calibrated specifically for cats, dogs & horses
- Biosensor auto code technology
- Accurate Results
- Easy to use blood glucose meter
- Small sample (0.7µl) of whole blood is required
- Accurate results displayed within 5 seconds
- Readable range 1.1 – 33.3 mmol/L
- 500 result automatic memory
- HCT range 20 - 60%
- Lifetime Warranty



Calibrated for Canine, Feline & Equine use

Tel: +44 (0) 1204 669033 (Option 1)
 Fax: +44 (0) 1204 669034
 Email: sales@woodleyequipment.com
 Web: www.woodleyequipment.com

WOODLEY
 EQUIPMENT COMPANY LTD.

OLD STATION PARK BUILDINGS, ST. JOHN STREET, HORWICH, BOLTON, LANCASHIRE, BL6 7NY, UK

Vcheck V200 POINT OF CARE ANALYSER

Simplify In-Practice Point of Care Testing with Reference Lab Quality - avoiding test referrals

Canine: T4, TSH, Cortisol, CRP, Progesterone, cPL, SDMA

Feline: T4, SAA, fPL, SDMA

Achieve true analysis with fluorescence technology

- Fully quantitative automated analyser
- Accurate diagnosis for Dogs and Cats in minutes
- Analyser provides print out and result storage



Canine Tests Available:

- T4
- TSH
- Cortisol
- CRP
- Progesterone
- cPL
- SDMA

Feline Tests Available:

- T4
- SAA
- fPL
- SDMA



Small analyser - low cost per test

InSight™ Lab Manager

Results available on your smartphone via:

A stand alone Lab Management System to integrate with your Practice Management System



Tel: +44 (0) 1204 669033 (Option 1)
 Fax: +44 (0) 1204 669034
 Email: sales@woodleyequipment.com
 Web: www.woodleyequipment.com

WOODLEY
 EQUIPMENT COMPANY LTD.

OLD STATION PARK BUILDINGS, ST. JOHN STREET, HORWICH, BOLTON, LANCASHIRE, BL6 7NY, UK



Rapid Test Kits

Now available exclusively from Woodley

Anigen™ Rapid FIV Ab/FeLV Ag

For the simultaneous detection of Feline Immunodeficiency virus antibody and Feline Leukemia Virus antigen in feline whole blood, plasma or serum

Anigen™ Rapid Giardia Ag

For the detection of Giardia antigen in canine faeces

Anigen™ Rapid CPV Ag

For the detection of Canine Parvo virus antigen in canine faeces

Anigen™ Rapid CaniV-4

For the detection of Dirofilaria immitis antigen, Ehrlichia canis antibody, Leishmania infantum antibody, Anaplasma phagocytophilum / Anaplasma platys antibody in whole blood, plasma or serum

Anigen™ Rapid FIV Ab

For the detection of Feline Immunodeficiency virus antibody in feline whole blood, plasma or serum

Anigen™ CPV/CCV Ag

For the detection of Canine Parvo virus and Corona virus antigen in canine faeces

Anigen™ Rapid FeLV Ag

For the detection of Feline Leukemia Virus antigen in feline whole blood, plasma or serum

Anigen™ Rapid FPV Ag

For the detection of Feline Parvo virus antigen in feline faeces

Anigen™ Rapid CDV Ag

For the detection of Canine Distemper Virus antigen in conjunctiva (recommended), urine, serum or plasma

Anigen™ FCoV Ag

For the detection of Feline Corona virus antigen in feline faeces

This list is not exhaustive - please contact us with your requirements

ImmunoComb® VacciCheck In-Practice Antibody Test Kit

ImmunoComb® VacciCheck Antibody Test Kit monitors serological status, reduces vaccination failure and prevents over vaccination consequences for dogs and cats.

- Rehome immediately able to know vaccination status

The ImmunoComb® VacciCheck is a user friendly, in-practice kit, which tests for antibody titres to the three core infections:

Canine

- Infectious Hepatitis (ICH)
- Parvovirus (CPV)
- Distemper (CDV)

Feline:

- Panleukopenia (FPLV)
- Herpes Virus (FHV)
- Calici Virus (FCV)

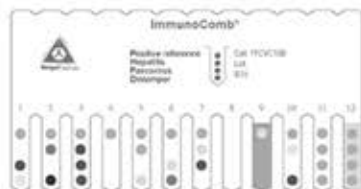

VacciCheck is recommended by the WSAVA to comply with regulations to reduce unnecessary vaccinations

InSight™ Urine Test Strips

- MS-11 Urine Strips Test for:

- Urobilinogen
- Glucose
- Bilirubin
- Ketone
- Specific Gravity
- Leucocytes
- Blood
- pH
- Protein
- Creatinine
- Nitrate

with urine protein / creatinine ratio

- MS-2 Urine Strips Test for:

- Microalbumin
 - Creatinine
- with urine microalbumin / creatinine ratio



InSight™ Urinalysis Reader

- Semi-automatic urine test strip reader with touch screen & printer to be used with InSight Urine Test Strips
- Simply dip the strip into the urine sample and place it on the strip loading plate
- Results displayed in 60 seconds



Tel: +44 (0) 1204 669033 (Option 1)
 Fax: +44 (0) 1204 669034
 Email: sales@woodleyequipment.com
 Web: www.woodleyequipment.com

WOODLEY
 EQUIPMENT COMPANY LTD.

OLD STATION PARK BUILDINGS, ST. JOHN STREET, HORWICH, BOLTON, LANCASHIRE, BL6 7NY, UK

NOW YOU HAVE A CHOICE

The 'Woodley Lab Systems'

Haematology, Clinical Chemistry,
Fluorescence, Coagulation & Urinalysis Analysers

System 1



InSight™ 5 Diff Retic
Haematology Analyser with laser

System 2



InSight™ V5 (no Retics)
Haematology Analyser with laser

Now includes
InSight Lab Manager
& Vcheck V200
Fluorescence Analyser



Skyla VB1 Chemistry
Analyser

Vcheck Point of Care
Fluorescence Analyser for cPL,
fPL, Canine Cortisol, T4 & more

InSight™ qLabs®
Veterinary
Coagulation Analyser

InSight™
Urinalysis
Analyser

All your laboratory needs in one 'Complete' System
for one low cost payment each month

- Includes Technical Support for 5 years
- Includes all repairs and servicing for 5 years
- Includes scheduled internal QC
- Includes 'Track your delivery'
- Includes InSight Lab Manager
- Includes software updates to improve analyser functionality and test range when appropriate
- Wet Chemistry, Endocrinology and Blood Gas options available

Contact Woodley or your Local Area Account Manager to discuss

Tel: +44 (0) 1204 669033 (Option 1)
Fax: +44 (0) 1204 669034
Email: sales@woodleyequipment.com
Web: www.woodleyequipment.com

WOODLEY
EQUIPMENT COMPANY LTD.

OLD STATION PARK BUILDINGS, ST. JOHN STREET, HORWICH, BOLTON, LANCASHIRE, BL6 7NY, UK

A stand alone Lab Management System to integrate with your Practice Management System



Lab Manager



Results available on your smartphone or tablet - access Lab Results anytime, anywhere

Compatible with



Reference Lab Quality Analysis

- Canine Tests: T4, TSH, Cortisol, CRP, Progesterone, cPL, SDMA
 - Feline Tests: T4, SAA, fPL, SDMA
- see page 4 for more information

Wet Chemistry, Endocrinology and Blood Gas Options



- InSight Lab Manager integrates your Lab Equipment with the host Practice Management System
- Alternatively InSight Lab Manager can be used as a stand alone Lab Management System
- Results are displayed alongside a Reference Range Bar Chart for easy identification of abnormal results

Contact Woodley or your Local Area Account Manager to discuss

Tel: +44 (0) 1204 669033 (Option 1)
 Fax: +44 (0) 1204 669034
 Email: sales@woodleyequipment.com
 Web: www.woodleyequipment.com

WOODLEY
 EQUIPMENT COMPANY LTD.

OLD STATION PARK BUILDINGS, ST. JOHN STREET, HORWICH, BOLTON, LANCASHIRE, BL6 7NY, UK

RapidVet®- H Crossmatch Kits

In-practice crossmatch test kits for use in transfusion medicine on either canine or feline patients. A companion animal crossmatch can now be performed in-practice prior to transfusion.

- Will detect all major canine and feline blood group incompatibilities
- Performed in-practice in 10 minutes
- Easy to use and results are clear
- Simple to use and quick to run
- Available in kits of 3 tests
- Minor Crossmatch Kits also available

Use alongside canine & feline blood typing kits

Essential for good transfusion practice



RapidVet®- H Blood Typing Kits - Canine & Feline

In-practice tests for rapid determination of Canine DEA 1.1 and Feline A, B or AB blood types.

These fast in-house blood typing card kits for cats or dogs are essential for transfusions and breeding decisions. They are fast, easy to use, economical and can be stored at room temperature.

RapidVet-H Feline

- For Feline A, B & AB
- Fast, easy, economical and VITAL
- Results in 2 minutes
- Auto-agglutination screen
- Requires 3 drops of whole blood
- Available in kits of 5

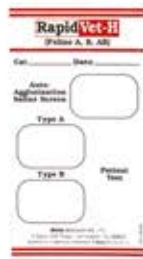

RapidVet-H Canine

- For Canine DEA 1.1
- Fast, easy, economical and VITAL
- Results in 2 minutes
- Auto-agglutination screen
- Requires 3 drops of whole blood
- Available in kits of 5
- Positive control

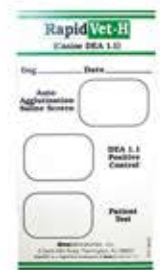

"Every dog & cat in need of a transfusion should be blood typed"

Dr. Urs Giger, Dr.med.vet., Dip ACVIM, ECVIM

Veterinary Parasep®

Faecal Filters

- Cleaner, safer method
- Separates eggs from faecal filter in safe, enclosed environment
- No possibility of cross contamination
- More accurate and consistent results
- No laborious, time consuming 'clean up' of sinks, shaker bottles and sieves



Haematology Atlas

Haematology Atlas written exclusively for Woodley Equipment Ltd by Kostas Papasoulitis DVM PhD DipRCPath MRCVS (Bristol Vet School).

Titles available: Canine, Feline and Equine

These atlases are an excellent microscope-side reference guide offering normal cell morphology.

- Erythrocytes
- Neutrophils
- Lymphocytes
- Eosinophils
- Basophils
- Platelets
- Methodology: Microhaematocrit
- Methodology: Blood Smears



Titles available: Canine, Feline & Equine

Tel: +44 (0) 1204 669033 (Option 1)
 Fax: +44 (0) 1204 669034
 Email: sales@woodleyequipment.com
 Web: www.woodleyequipment.com

WOODLEY
 EQUIPMENT COMPANY LTD.

OLD STATION PARK BUILDINGS, ST. JOHN STREET, HORWICH, BOLTON, LANCASHIRE, BL6 7NY, UK

PocketChem™ BA Blood Ammonia Measurement

- Whole blood measurement
- Ready for use 24 hours a day
- Small sample volume
- Battery powered
- Easy to maintain
- Temperature compensation
- Data management function
- Lightweight and compact design
- Uses exclusive reagent strips without any pre-treatment
- Detachable printer available



*World's only
Point of Care
Blood Ammonia
Analyser*

Clinispin MPC Multi Purpose Centrifuge

- Includes 2 Rotors:
 - HCT / QBC® rotor (24 x HCT/QBC®)
 - Microtube rotor (12 x 2ml)
- 3 Pre-Defined Presets:
 - HCT / QBC®, Serum / Plasma and Urine
- Variable Speed and Time
- Displays RPM or RCF (g force)
- Quiet Operation
- Easy to Use



StatStrip® Lactate Xpress Meter

- Results in 13 seconds
- Easy to use and portable
- Small 0.6µl sample size
- Venous or arterial whole blood
- Stores 400 patient results
- No user calibration
- Eliminates interfering substances



StatSensor® Creatinine Xpress Meter

- Rapid assessment of kidney function
- Results in 30 seconds
- Easy to use
- Small 1.2µl sample size
- Capillary, venous or arterial whole blood
- Stores 400 patient results
- Correct results for HCT
- No user calibration
- Eliminates interfering substances



NovaVet Blood Ketone Meter

- Measures blood beta-hydroxybutrate (BHBA), the gold standard for detecting subclinical ketosis
- Useful for predicting and monitoring diabetic ketoacidosis
- Ready to use, disposable biosensor
- No calibration required
- Simple test procedure in the field
- Accurate, quantitative blood ketone results in 10 seconds
- Small sample volume
- Stores 400 results



InSight™ Microscope Eyepiece Adapter for Smartphones



- Mounts any smartphone to any microscope in minutes!
- Smartphone camera can then capture photos & videos for real-time viewing on smartphone screen, via video conferencing, emailing or sharing online

*Capture & share
microscopic images*

Vision V5000 Microscope

- LED illuminator
- Excellent optical resolution
- Wide-field eyepieces
- Dioptric compensation
- DIN achromatic objectives 4x, 10x, 40x, 100x (60x available)
- Coaxial coarse and fine focusing



InSight™ 50x Microscope Lens

- Mounts onto any Smartphone
- Enhances the Smartphone camera
- Captures high quality microscopic images & video
- Requires no batteries



Tel: +44 (0) 1204 669033 (Option 1)
 Fax: +44 (0) 1204 669034
 Email: sales@woodleyequipment.com
 Web: www.woodleyequipment.com

WOODLEY
 EQUIPMENT COMPANY LTD.

OLD STATION PARK BUILDINGS, ST. JOHN STREET, HORWICH, BOLTON, LANCASHIRE, BL6 7NY, UK



A stand alone
Lab Management System
which can integrate to your
Practice Management System

LAB MANAGER

- InSight Lab Manager integrates your Lab Equipment with the host Practice Management System
- Alternatively InSight Lab Manager can be used as a stand alone Lab Management System
- Results are displayed alongside a Reference Range Bar Chart for easy identification of abnormal results
- Smartphone and tablet friendly - access Lab Results anytime, anywhere



InSight™ EVOLUTION WET CHEMISTRY ANALYSER



Available as a low cost package
including analyser, reagents
and service.

Suitable for small to medium
sized practices or for multi-site
placements.

INSIGHT EVOLUTION WET CHEMISTRY ANALYSER

Fully automated clinical chemistry analyser, which uses liquid reagents and is approximately 70% cheaper to run than dry chemistry.

- Easy to use with colour touch screen
- Fully automatic - no manual pipetting required
- Minimal user maintenance
- Cost effective with fast and accurate results
- Flexible testing - single and profile testing
- Small footprint with integral printer to fit any size laboratory
- 'Special tests' for small animals include: T4, Fructosamine, Bile Acids, Phenobarbitone and Urine Protein/Creatinine ratio
- 'Special tests' for large animals include: SAA, Fibrinogen, BHB, GGT, GLDH, Magnesium, Triglycerides, NEFA, Haemoglobin and Chloride
- Integration to most Practice Management Systems

*Fully supported Nationwide by our Specialist
Team of Field Service Technicians*



THE AIA-360 ANALYSER

Offers the automation powers and performance of a large analyser in a benchtop format. Random access allows any combination of tests, in any order at any time and a throughput of 36 results per hour with the first test result in 20 minutes ensures a fast reliable service.

- Simple to use
- Fast, reliable results
- Simple maintenance
- Touchscreen with intuitive menus

Key Assays Available:

- Free T4
- Total T4
- Cortisol
- Progesterone
- ACTH
- Insulin
- cTnI

*Fully supported Nationwide
by our Specialist Team of
Field Service Technicians*

Take a 360 degree look at your
endocrinology testing with
the TOSOH AIA-360

Tel: +44 (0) 1204 669033 (Option 1)
Fax: +44 (0) 1204 669034
Email: sales@woodleyequipment.com
Web: www.woodleyequipment.com

WOODLEY
EQUIPMENT COMPANY LTD.

OLD STATION PARK BUILDINGS, ST. JOHN STREET, HORWICH, BOLTON, LANCASHIRE, BL6 7NY, UK

InSight™ V5

A fully automated multi-species Haematology Analyser with Laser ideal for in-practice use

Laser Technology

HAEMATOTOLOGY ANALYSERS

- Quick and easy to use
- Large user-friendly colour touch screen
- Low maintenance
- Fully automated
- High performance - 23 haematology parameters
- 60 second analysis time
- Small sample volume - 15µl whole blood
- Compact benchtop size
- Stores up to 50,000 results
- Species specific reference ranges for dog, cat, rabbit, horse & cow



Both Analysers Integrate with Practice Management Systems

InSight™ 5 Diff Retic

A true 5 part differential laser Haematology Analyser Including **Reticulocytes**

- Compact, benchtop size
- Small sample volume - 20µl whole blood
- True 27 parameter system
- 2 minute cycle time
- Precision equal to larger laboratory analyser
- Quick and easy operation
- Species specific reference ranges
- Low maintenance
- Over 50 species on board



Uses Dual Laser and Impedance Technology

skyla VB1

For both Rotor Profiles & Single/Dual Tests

Highly accurate test results in under 15 minutes

Integrates with InSight Lab Manager - a stand alone Lab Management System which can integrate to your Practice Management System

VETERINARY CHEMISTRY ANALYSER

- Fast and reliable
- Compact, benchtop size
- Performs up to 15 biochemistry tests simultaneously
- Performs up to 3 single/dual tests simultaneously
- 200µl whole blood, serum or plasma
- High accuracy at Point-Of-Care (POC)
- Precision equal to larger laboratory analyser
- No specialised training required
- LCD colour touch screen & built in printer
- Fully automatic system with walk away operation
- Built in QC and calibration for each test
- Species specific reference ranges
- Stores up to 50,000 results



InSight™ LAB MANAGER



Parameters Available

ALB, ALP, ALT, AMY, AST, BUN, Ca, Cl⁻, CREA, CPK, GGT, GLU, K⁺, Na⁺, PHOS, TBIL, CHOL, TP, B Acids, T4, Mg, UA, TCO₂, TRIG, LAC, FRU, LIPA, UCRE, UPRO, GLOB*, A/G*, Na⁺/K⁺, BUN/CREA*, UPC*, UREA* * Calculated

Single Test

- CREA
- Cl⁻
- AMY
- BUN
- TBIL
- LAC

Dual Test

- Na⁺ & K⁺
- PHOS & Ca
- CHOL & TRIG
- GGT & CPK
- ALT & ALP
- ALB & TP
- AST & CPK
- LIPA & AMY
- UPC Kit

(UPRO & UCRE)

Integrates with Practice Management Systems

Tel: +44 (0) 1204 669033 (Option 1)
 Fax: +44 (0) 1204 669034
 Email: sales@woodleyequipment.com
 Web: www.woodleyequipment.com

WOODLEY
 EQUIPMENT COMPANY LTD.

OLD STATION PARK BUILDINGS, ST. JOHN STREET, HORWICH, BOLTON, LANCASHIRE, BL6 7NY, UK

In-Practice Urinalysis in 24 hours simplified with

InSight™ Urinalysis

A 2-stage process available 24 hours a day

1. RapidBac™ Vet

TEST FOR BACTERIURIA

- * Negative - no bacteriuria indicated
- * Positive - proceed to Flexicult Vet

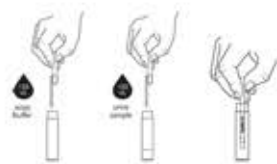

Results in 20 minutes

RapidBac™ Vet is a lateral flow immunoassay for the detection of Gram positive and Gram negative bacteria in dog and cat urine.

- Test immediately in-practice
- Results in less than 20 minutes
- Easy to use
- Room temperature storage
- 98.5% accuracy
- No special apparatus required

Proceed with Flexicult® Vet if RapidBac™ is positive or if antibiotic confirmation is needed

2. Flexicult® Vet

Chromogenic In-Practice Urine Culture & Sensitivity Test

Results within 24 hours

Flexicult® Vet is a 24 hour chromogenic culture test for diagnosing UTI's in dogs and cats. It aids the identification and quantification of bacteria and helps select the most appropriate antibiotic for effective patient management.



Flexicult Vet contains the following antibiotics:

- Ampicillin
- Amoxicillin/clavulanate
- Cephalotin
- Enrofloxacin
- Trimethoprim/sulfamethoxazole

Agar plate contains a chromogenic substance

Causes bacterial colonies on the agar to appear with different colours depending on the bacterium species



Examples of Flexicult Vet inoculated with E. coli (left) and E. faecalis (right)

Perform in-house without the need for specialist knowledge

Urinalysis Atlas

- Sample collections
- Physical characteristics
- Examination of sediment
- Photographic identification of casts
- Physical characteristics
- Contaminants in urine sediment



InSight Urinalysis Reader & Test Strips - see page 5



Incubator required: available **FREE OF CHARGE** for qualifying customers*

***DON'T MISS OUT - CONTACT US TODAY**

Tel: +44 (0) 1204 669033 (Option 1)
 Fax: +44 (0) 1204 669034
 Email: sales@woodleyequipment.com
 Web: www.woodleyequipment.com

WOODLEY
 EQUIPMENT COMPANY LTD.

OLD STATION PARK BUILDINGS, ST. JOHN STREET, HORWICH, BOLTON, LANCASHIRE, BL6 7NY, UK